

Meetings & Event Guide.

OMNI BARTON CREEK RESORT & SPA



EXPERIENCES MATTER HERE



OMNI
BARTON CREEK



Inspired spaces for INSPIRING EVENTS.

Discover the true essence of Texas at Omni Barton Creek Resort & Spa, nestled among the rolling hills of the Texas Hill Country. Immerse yourself in the breathtaking panoramic views surrounding this serene property, from the welcoming guest rooms to the pool decks and event spaces.

With over 76,000 square feet of flexible meeting and event space, Omni Barton Creek offers a range of options to accommodate any gathering. Whether you prefer the elegance of our ballrooms or the open-air ambiance of our expansive lawns, you can create a memorable event that seamlessly blends with the natural beauty of the landscape. Immerse yourself in the splendor of the rolling terrain.



about Omni Barton Creek Resort & Spa.

GATEWAY TO THE TEXAS HILL COUNTRY

The Omni Barton Creek Resort & Spa offers a tranquil retreat among the gentle slopes and ancient trees of Central Texas. With premium golf courses, a serene spa, pools for adults and families and so much more, this engaging resort is a welcome getaway for business travelers and families. Enjoy a slower pace of life amid the abundant sunshine of this urban retreat.



- 493 inviting guest rooms and suites take their design inspiration from the surrounding Texas landscape
- Over 76,000 square feet of flexible meeting, event and pre-function space, including the 14,532-square-foot Brazos Ballroom, 15,000 square feet of event lawns and the indoor/outdoor Hill Country Pavilion
- On-site audiovisual equipment services offering the latest technology and Wi-Fi internet access
- Four distinct 18-hole golf courses, each with stunning Hill Country scenery; courses include top-rated Fazio Canyons and Fazio Foothills designed by legendary Tom Fazio, Coore Crenshaw designed by golf great Ben Crenshaw, and Palmer Lakeside designed by iconic master Arnold Palmer.
- An expansive poolscape including an adults-only infinity pool and hot tub overlooking the hills, and two family-friendly pools plus splash pad
- Eight unique dining experiences, including healthy, seasonal dishes at Blind Salamander; nationally renowned steakhouse Bob's Steak & Chop House; 19th hole Crenshaw's Bar & Eatery; sleek lobby bar Jim Bob's Lobby Lounge; Latin-inspired restaurant Nopales; poolside dining with fruity and frozen drinks from Travis Pool Bar & Grill.
- Mokara Spa, a 13,000-square-foot oasis inspired by nearby creeks and springs with private adults-only rooftop pool, sauna, steam room, hot tub and a comprehensive selection of body and facial treatments
- A 33,000-square-foot fitness center offering group fitness classes or individual exercise with Peloton® bikes, free weights, indoor lap pool, running track and much more

Contact aurst.leads@omnihotels.com to book your next event.

Flexible, Next Generation Event & Meeting Space.

HILL COUNTRY PAVILION

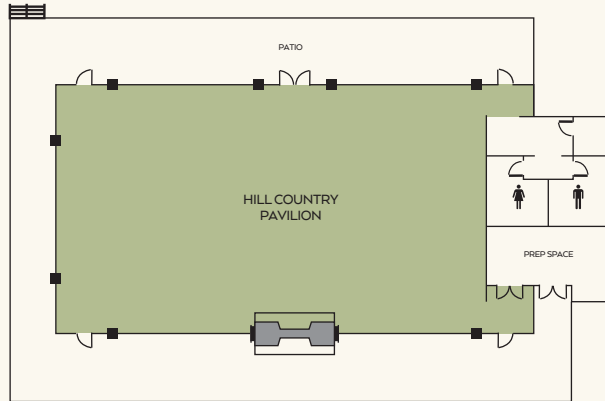

CONFERENCE LEVEL
(CEDAR)

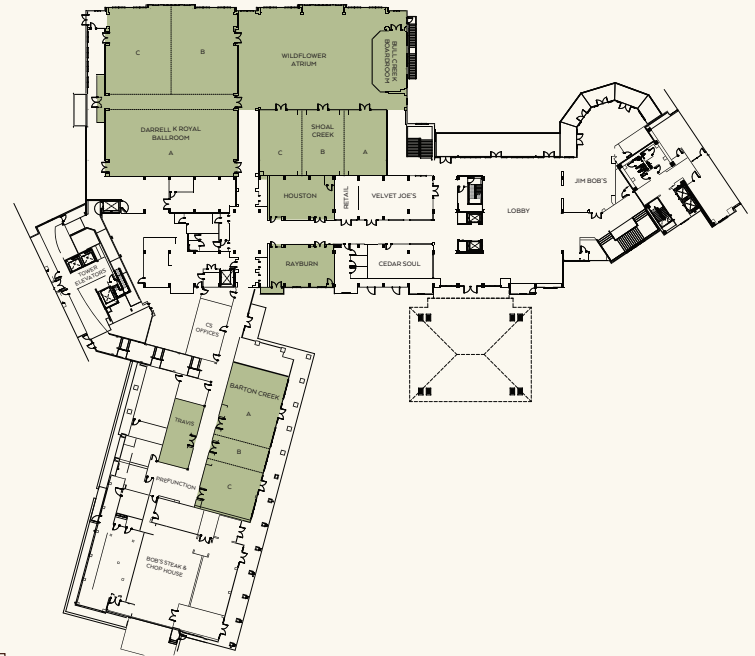

LOBBY LEVEL
(BLUEBONNET)

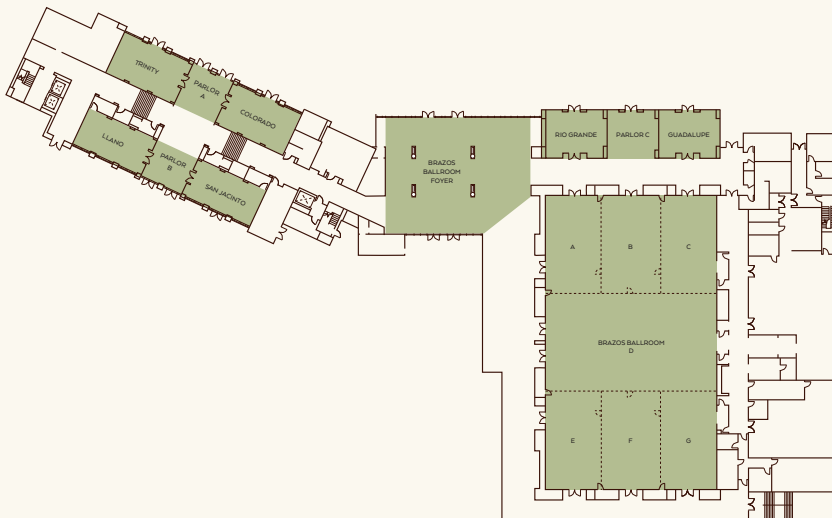

	SQUARE FOOTAGE	DIMENSIONS	WINDOWS	CEILING HEIGHT	BANQUET 72"	THEATER	CLASSROOM 18"	RECEPTION	CONFERENCE
MAIN LEVEL									
BARTON CREEK	2,850	89'X32'	YES	16'	140	345	120	220	—
A	1,440	46'X32'	YES	16'	60	160	56	110	24
B	450	14'X32'	YES	16'	20	54	—	30	16
C	960	30'X32'	YES	16'	40	128	30	70	16
A & B	1,890	59'X32'	YES	16'	100	240	80	145	32
B & C	1,410	44'X32'	YES	16'	80	192	56	110	24
HOUSTON	967	37.8'X25.6'	—	12'	50	96	30	70	20
RAYBURN	1,015	39.5'X25.7'	YES	12'	50	96	36	75	20
TRAVIS	701	17.83'X39'	—	16'	30	56	20	40	16
DARRELL K ROYAL BALLROOM	8,240	103'X80'	YES	12'	460	900	270	700	—
A	3,200/3,920	40'X80'	—	12'	180	400	108	250	—
B	2,160	54'X40'	YES	12'	90	200	60	210	28
C	2,160	54'X40'	YES	12'	90	200	60	210	28
B & C	4,320/5,040	54'X80'	—	12'	180	360	126	300	—
SHOAL CREEK	2,964	76'X39'	—	12'	180	360	120	225	—
A	988	25.3'X39'	—	12'	60	160	36	75	20
B	988	25.3'X39'	—	12'	60	160	36	75	20
C	988	25.3'X39'	—	12'	60	160	36	75	20
A & B OR B & C	1,976	50.5'X39'	—	12'	120	270	72	150	28
BULL CREEK BOARDROOM	740	20'X37'	YES	12'	—	—	—	—	22
WILDFLOWER ATRIUM	2,600	65'X40'	YES	12'	180	—	—	300	—
LOWER LEVEL									
BRAZOS BALLROOM	14,532	92'X158'	—	24'	780	1,800	630	1,250	—
A, B, C & D	9,686	92'X105.3'	—	24'	540	1,320	448	850	—
A, B & C	4,846	92'X52.8'	—	24'	280	810	216	450	—
A	1,632	31'X52.8'	—	24'	80	270	72	155	46
B	1,577	30'X52.8'	—	24'	80	270	72	150	46
C	1,637	31.1'X52.8'	—	24'	80	288	72	155	46
D	4,840	92'X52.7'	—	24'	280	810	238	450	86
E	1,632	31'X52.8'	—	24'	80	270	72	155	46
F	1,577	30'X52.8'	—	24'	80	270	72	150	46
G	1,637	31.1'X52.8'	—	24'	80	288	72	155	46
BRAZOS BALLROOM FOYER	5,414	83.6'X63.2'	YES	17'	—	—	—	541	—
TRINITY	850	40'X24.6'	YES	14'	40	126	30	80	16
COLORADO	950	40'X24.6'	YES	14'	50	140	36	80	20
PARLOR A	652	23.9'X25.1'	—	14'	—	—	—	65	—
LLANO	950	39.8'X21.8'	YES	14'	50	140	36	75	20
SAN JACINTO	950	39.8'X21.8'	YES	14'	50	140	36	75	20
PARLOR B	717	23.9'X29'	—	14'	—	—	—	72	—
RIO GRANDE	754	32.9'X25.4'	YES	14'	50	108	30	70	16
GUADALUPE	754	32.9'X25.4'	YES	14'	50	108	30	70	16
PARLOR C	706	29.3'X26'	—	14'	—	—	—	71	—
OUTDOOR SPACE									
HILL COUNTRY PAVILION	5,556	93.1'X59.3'	—	20'	280	720	—	500	—
HILL COUNTRY COURTYARD	2,892	—	—	—	—	—	—	—	—
HILL COUNTRY LAWN	10,400	—	—	—	500	—	—	—	—
LADY BIRD LAWN	4,593	—	—	—	—	—	—	150	—
LONGHORN LAWN	6,000	—	—	—	130	—	—	—	—
ROCK HOUSE	7,500	—	—	—	150	—	—	—	—

MEETING ROOM CAPACITIES WERE DETERMINED USING 72" ROUNDS OF 10 (ROUNDS CAPACITY), THREE CHAIRS PER 6'X30" TABLE (U-SHAPE CAPACITY) AND THREE CHAIRS PER 6'X18" TABLE (CLASSROOM CAPACITY) ALLOWING FOR MINIMAL AUDIOVISUAL EQUIPMENT.

Austin

highlights.

At the entrance to the famous Texas Hill Country, Omni Barton Creek Resort & Spa encourages you to slow down and disconnect. Take in the area's natural beauty at expansive natural areas and world class golf courses. Head further into the hills to tour the wineries of the Texas Wine Trail. Just a short drive away, creative Austin will keep you busy with fantastic restaurants, eclectic shopping and legendary music that has made Austin the Live Music Capital of the World.

AIRPORTS

Austin-Bergstrom International Airport | 26 min

ATTRACTIONS

Congress Avenue Bat Bridge | 21 min
Bob Bullock Texas State History Museum | 23 min
Texas State Capitol/Texas Capitol Visitors Center | 23 min
Lyndon B. Johnson Presidential Library and Museum | 29 min

RECREATION

Wild Basin Wilderness Preserve | 8 min
Zilker Botanical Garden | 16 min
Barton Springs/Zilker Park | 18 min
Lady Bird Johnson Wildflower Center | 21 min
South Congress Avenue | 23 min
Hill Country Helicopter Tours | 34 min

ENTERTAINMENT

ACL Live at the Moody Theater | 21 min
Moody Center | 25 min
Circuit of the Americas Racetrack | 38 min



OMNI BARTON CREEK RESORT & SPA
8212 BARTON CLUB DRIVE
AUSTIN, TEXAS 778735
OMNIHOTELS.COM/BARTONCREEK

