

Meetings & Event Guide.

OMNI DALLAS HOTEL



EXPERIENCES MATTER HERE



OMNI
DALLAS

Table *of* Contents.

MEETINGS & EVENTS OVERVIEW	01
ABOUT.....	02
EVENT VENUES	04
HIGHLIGHTS.....	08



Right in the MIDDLE OF IT ALL.

Omni Dallas Hotel celebrates the vibrancy of the city, from its artistic culture to its tranquil pool deck and soothing treatments at Mokara Spa to create a memorable experience for every visitor. Each of our 1,001 guest rooms is finished in contemporary comfort, featuring creative works by local artists and expansive windows that highlight stunning city views.

Situated just 20 minutes from DFW International Airport, Omni Dallas Hotel is conveniently located for corporate events, conferences, weddings and exceptional celebrations. Connected to the Kay Bailey Hutchison Convention Center, attendees can easily travel back and forth via sky bridge. An expansive 110,000 square feet of flexible indoor/outdoor event space set the stage for an unforgettable gathering.



about Omni Dallas Hotel.

TEXAS HOSPITALITY AND CITY STYLE

At the premier urban hotel in downtown Dallas, you'll find an inviting home base for your city exploration. Lounge by the heated rooftop infinity pool, with skyline views beyond. Take a foodie tour through the eight connected dining concepts at Restaurants on Lamar. Schedule a relaxing massage or body scrub at Mokara Spa, a tranquil retreat at the heart of the city.





An event to remember.

- 1,001 spacious guest rooms featuring modern decor and works by local artists
- 110,000 square feet of flexible indoor and outdoor meeting, event and pre-function space, including the nearly 32,000 square foot Dallas Ballroom
- Restaurants on Lamar available for private block parties and Pegasus Lawn for events for up to 5,000 guests
- Fast Wi-Fi, the latest AV technology and helpful professional services
- Premium catering featuring locally-sourced ingredients whenever possible
- Uptown Terrace with heated infinity pool and views of downtown Dallas; enjoy signature cocktails and light bites at Uptown Terrace Pool Bar & Grill
- Ten unique dining venues including the Restaurants on Lamar, a one-of-a-kind food and drink experience featuring upscale Mexican at Cafe Herrera, Texas farm-to-table cuisine at Texas Spice, traditional Asian dishes with a modern American twist and much more
- Soothing body treatments and salon services at Mokara Spa
- Expansive state-of-the-art fitness center
- Walking distance to the DART light rail for easy transportation to DFW or Dallas Love Field from Union Station
- Board DART's D-Link bus directly from the hotel for complimentary transportation to the Bishop Arts District, Victory Park, The Cedars and lower Uptown

Flexible Event & Meeting Space.

LEVEL ONE

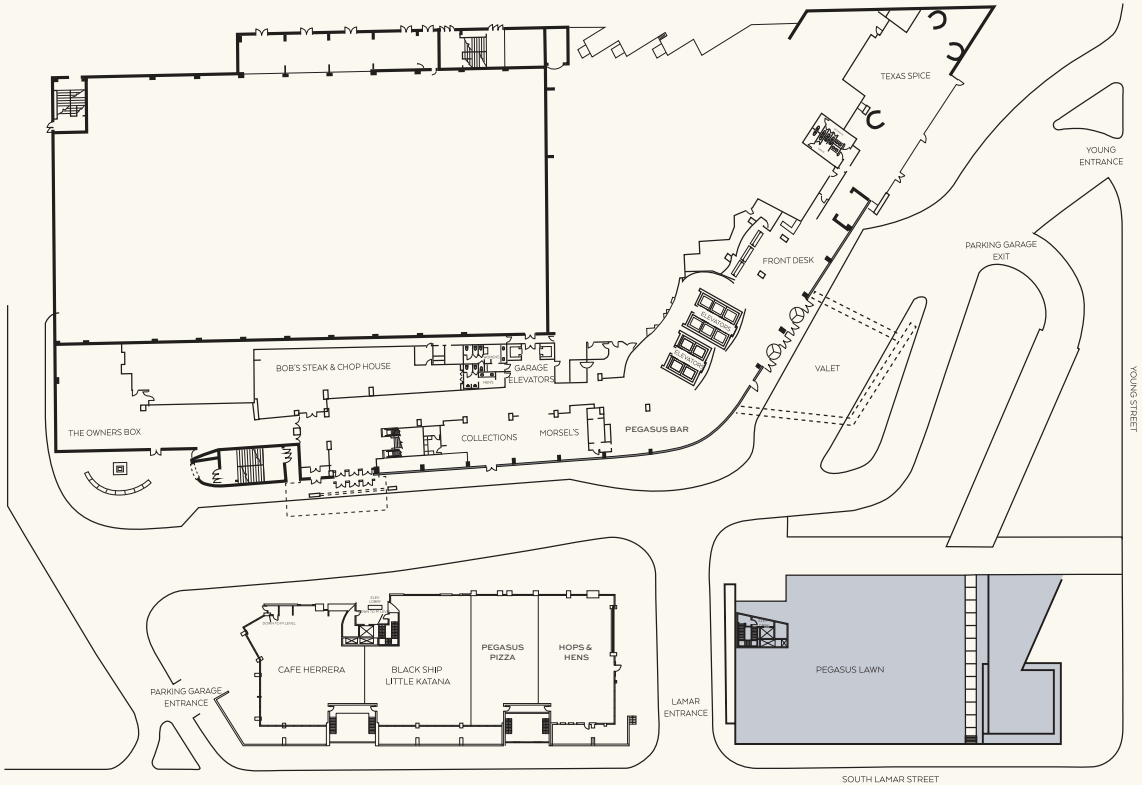

Meeting Room Capacities Were Determined Using 72" Rounds Of 12 (Rounds Capacity), Three Chairs Per 6'X30" Table (U-Shape Capacity) And Three Chairs Per 6'X18" Table (Classroom Capacity)

	DIMENSIONS L x W	SQUARE FOOTAGE	THEATER	BANQUET STYLE 72" ROUND	RECEPTION
LEVEL ONE					
PEGASUS LAWN	142' X 118'	12,000	-	800	1,500
PEGASUS STAGE	40' X 40'	1,600	-	-	-

Flexible Event & Meeting Space.

LEVEL TWO

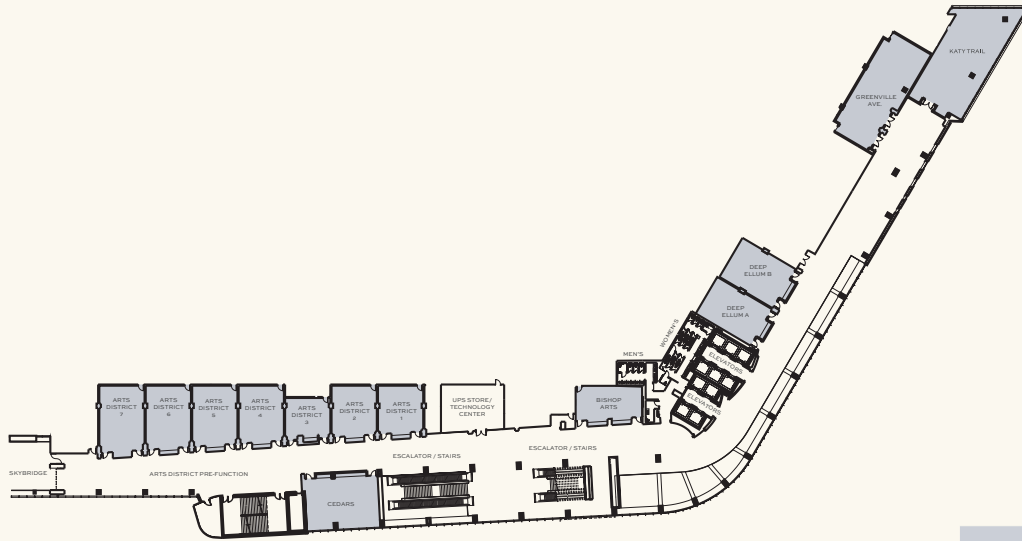

Meeting Room Capacities Were Determined Using 72" Rounds Of 12 (Rounds Capacity), Three Chairs Per 6'X30" Table (U-Shape Capacity) And Three Chairs Per 6'X18" Table (Classroom Capacity)

	DIMENSIONS LxW	SQUARE FOOTAGE	CEILING HEIGHT	THEATER	CLASS-ROOM 18" DESKS	BANQUET STYLE 72" ROUND	CONFERENCE STYLE	U-SHAPE	HOLLOW SQUARE	RECEPTION
LEVEL TWO										
2ND FLOOR SKYBRIDGE	153'x49'	4,837	-	-	-	-	-	-	-	250
ARTS DISTRICT FOYER	236'x557'	18,923	15'	-	-	-	-	-	-	-
ARTS DISTRICT 1	33'x27'	797	15'	80	60	48	18	12	18	83
ARTS DISTRICT 2	34'x27'	847	15'	84	60	48	18	12	18	89
ARTS DISTRICT 3	27'x27'	660	15'	50	40	36	12	10	18	69
ARTS DISTRICT 4	40'x27'	946	15'	95	50	60	24	20	26	99
ARTS DISTRICT 5	41'x27'	999	15'	95	60	60	24	20	26	105
ARTS DISTRICT 6	42'x27'	1,047	15'	104	60	72	28	24	30	110
ARTS DISTRICT 7	44'x27'	1,097	15'	105	60	72	28	24	30	115
BISHOP ARTS BOARDROOM	30'x19'	804	13'	-	-	-	24	-	-	-
CEDARS	30'x45'	1,393	16'	110	72	84	30	36	36	146
DEEP ELLUM A	43'x25'	1,015	15'	90	60	60	30	24	30	106
DEEP ELLUM B	42'x27'	1,052	15'	90	60	60	30	24	30	110
GREENVILLE AVENUE	29'x69'	1,883	15'	160	100	120	48	39	48	198
KATY TRAIL	81'x111'	2,404	15'	172	100	144	48	39	48	253
KATY TRAIL FOYER	52'x48'	1,349	15'	-	-	-	-	-	-	142

Flexible Event & Meeting Space.

LEVEL THREE

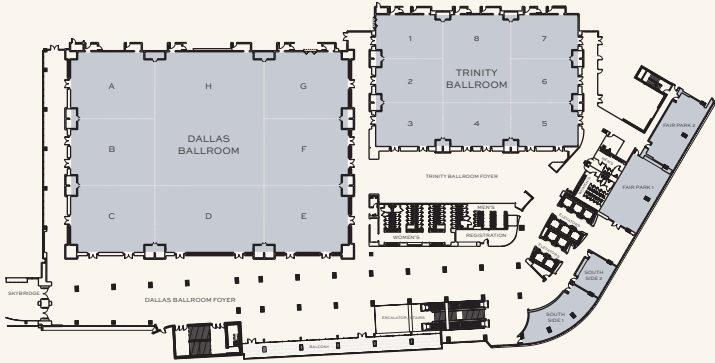

	DIMENSIONS LxW	SQUARE FOOTAGE	CEILING HEIGHT	THEATER	CLASS-ROOM 18" DESKS	BANQUET STYLE 72" ROUND	CONFERENCE STYLE	U-SHAPE	HOLLOW SQUARE	RECEPTION
LEVEL THREE										
3RD FLOOR SKYBRIDGE	31'x72'	1628	16.8'	-	-	-	-	-	-	-
DALLAS BALLROOM	214'x152'	31,704	32'	3,700	2180	2210	-	-	-	3,340
DALLAS FOYER	237'x370'	24,460	27'	-	-	-	-	-	-	2,570
DALLAS A	51'x64	3,124	32'	300	140	192	50	50	70	330
DALLAS B	51'x64	3,158	32'	320	160	240	50	50	70	330
DALLAS C	51' 66'	3,124	32'	320	160	240	50	50	70	330
DALLAS D	51'x86'	4,269	32'	420	260	336	60	60	80	450
DALLAS E	51'x64'	3,121	32'	320	160	240	50	50	70	330
DALLAS F	51'x64'	3,155	32'	320	160	240	50	50	70	330
DALLAS G	51'x66'	3,121	32'	300	140	192	50	50	70	330
DALLAS H	102'x86'	8,632	32'	940	490	672	-	-	-	910
DALLAS A,B	102'x64'	6,282	32'	650	360	360	-	-	-	660
DALLAS A,B,C	152'x64'	9,407	32'	900	500	520	-	-	-	990
DALLAS A,B,C,D,H	152'x150	22,308	32'	2600	1510	1,500	-	-	-	2,350
DALLAS A,B,F,G,H	102'x214'	21,900	32'	2,480	1480	1580	-	-	-	2,230
DALLAS A,B,H	102'x150'	14,915	32'	1,600	1,000	980	-	-	-	1,570
DALLAS B,C	102 x 64	6,283	32'	680	320	360	-	-	-	660
DALLAS C,D	51'x150'	7,393	32'	670	350	420	-	-	-	780
DALLAS C,D,E	51'x214'	10,514	32'	980	500	600	-	-	-	1,110
DALLAS D,E	51'x150'	7,389	32'	740	350	330	-	-	-	780
DALLAS D,E,F,G,H	152'x150'	22,297	32'	2,520	1,400	1380	-	-	-	2,350
DALLAS D,H	152x86'	12,901	32'	1,440	840	850	-	-	-	1,360
DALLAS E,F	102 x 64	6,276	32'	620	340	360	-	-	-	660
DALLAS E,F,G	152 x64'	9,396	32'	980	500	520	-	-	-	990
DALLAS F,G	102' x 64'	6,276	32'	650	340	360	-	-	-	660
DALLAS F,G,H	102'x150'	14,908	32'	1,600	1,040	1,040	-	-	-	1570
FAIR PARK 1 FOYER	27'x33'	845	-	-	-	-	-	-	-	50
FAIR PARK 1	55'x33'	1,748	13'	120	80	108	40	30	40	180
FAIR PARK 2	27'x55'	1,438	13'	110	60	96	40	30	40	150
SOUTH SIDE 1	26 x 66	1,160	12'	45	24	60	16	14	16	100
SOUTH SIDE 2	21' x 27'	605	12'	30	26	24	14	11	14	30
TRINITY BALLROOM	100'x154	15,400	28'	1470	860	920	-	-	-	1560
TRINITY FOYER	144'x42"	5,053	12'	-	-	-	-	-	-	530
TRINITY 1	33'x52'	1,639	28'	168	80	108	40	40	50	170
TRINITY 2	34'x52'	1,649	28'	168	80	108	40	40	50	170
TRINITY 3	33' x 52'	1,636	28'	168	80	108	40	40	50	170
TRINITY 4	33' 5 52'	1,644	28'	168	80	108	40	40	50	170
TRINITY 5	33'x51'	1,613	28'	168	80	108	40	40	50	170
TRINITY 6	33'x51'	1,619	28'	168	80	108	40	40	50	170
TRINITY 7	33' x 51'	1,623	28'	168	80	108	40	40	50	170
TRINITY 8	67' x 52'	3,383	28'	340	200	240	-	-	-	360
TRINITY 1,2	67'x52'	3,289	28'	350	190	180	70	60	70	340
TRINITY 1,2,3	100'x52'	4,924	28'	470	230	270	-	-	-	510
TRINITY 1,2,8	67'x103'	6,671	28'	760	460	410	-	-	-	700
TRINITY 1,2,3,4,8	100' x 103'	9,848	28'	1,050	570	720	-	-	-	1,040
TRINITY 1,2,6,7,8	67' x 154'	9913	28'	1130	650	670	-	-	-	1,040
TRINITY 2,3	67 x 52	3,286	28'	320	140	180	70	60	70	350
TRINITY 3,4	33 x 103	3,280	28'	280	180	160	70	60	70	350
TRINITY 3,4,5	33'x154'	4,826	28'	430	270	250	-	-	-	510
TRINITY 4,5	33'x102'	3,257	28'	270	170	160	70	60	70	340
TRINITY 4,8	100'x552'	5,027	28'	520	216	240	-	-	-	530
TRINITY 4,5,6,7,8	100'x100'	9882	28'	1,050	570	720	-	-	-	1,040
TRINITY 5,6	96'x51'	3,232	28'	290	144	180	70	60	70	340
TRINITY 5,6,7	100'x51'	4,855	28'	490	230	270	-	-	-	510
TRINITY 6,7	67'x51'	3,242	28'	320	190	180	70	60	70	340
TRINITY 6,7,8	67'x102'	6,625	28'	700	420	410	-	-	-	700

Meeting Room Capacities Were Determined Using 72" Rounds Of 12 (Rounds Capacity), Three Chairs Per 6'X30" Table (U-Shape Capacity) And Three Chairs Per 6'X18" Table (Classroom Capacity)

Flexible Event & Meeting Space.

LEVEL FIVE

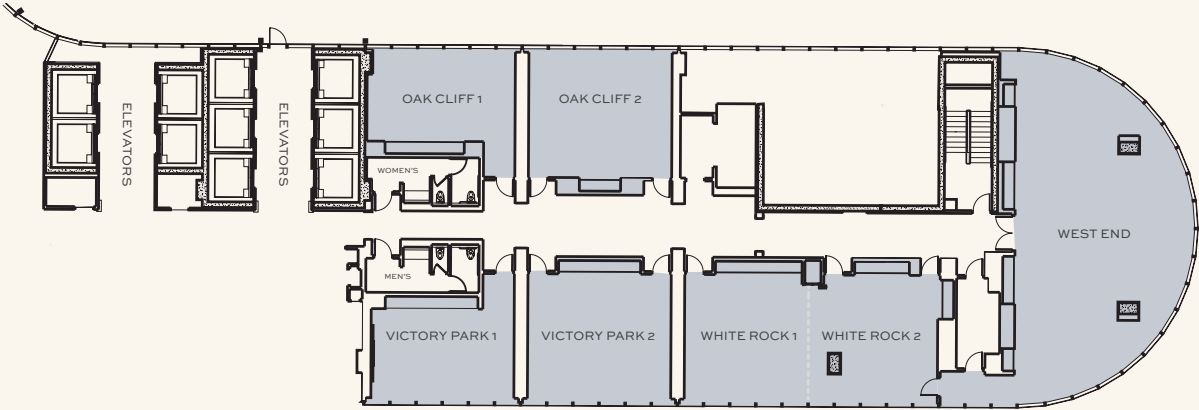

Meeting Room Capacities Were Determined Using 72" Rounds Of 12 (Rounds Capacity), Three Chairs Per 6'X30" Table (U-Shape Capacity) And Three Chairs Per 6'X18" Table (Classroom Capacity)

	DIMEN- SIONS LxW	SQUARE FOOTAGE	CEILING HEIGHT	THEATER	CLASS- ROOM 18" DESKS	BANQUET STYLE 72" ROUND	CONF- ER- ENCE STYLE	U-SHAPE	HOLLOW SQUARE	RECEPTION
LEVEL FIVE										
OAK CLIFF 1	18'x26'	483	8.2'	30	20	24	20	12	15	30
OAK CLIFF 2	25'x26'	589	8.2'	40	30	48	20	12	15	30
VICTORY PARK 1 BOARDROOM	21'x26'	489	8.2'	-	-	-	14	-	-	-
VICTORY PARK 2	25'x26'	603	8.2'	40	30	48	20	12	15	30
WHITE ROCK 1	25'x22'	536	8.2'	30	18	24	12	12	18	20
WHITE ROCK 2	25'x26'	536	8.2'	25	12	24	12	9	12	20
WHITE ROCK	22'x48'	1,064	8.2'	70	36	36	20	20	30	50
WEST END	35'x62'	1,676	8.2'	80	40	72	36	30	36	170

Dallas

highlights.

Downtown Dallas buzzes with creative energy and local enthusiasm. Soak up the culture of the city, from the symphony and ballet, to the beloved Dallas Mavericks. Walk to the West End or Victory Park for lively nightlife and live music, or explore fascinating museums and beautiful outdoor parks. Come prepared to shop, with upscale retailers, charming boutiques and popular outlet stores across the city.

AIRPORTS

DFW International Airport | 27 min
Love Field Airport | 20 min

ATTRACTIONS

West End Historic District | 6 blocks
Perot Museum of Nature and Science | 13 blocks
Dallas Zoo | 6 min
Dallas Arboretum and Botanical Garden | 17 min
AT&T Discovery District | 4 min
Fair Park | 8 min

ARTS & CULTURE

Dallas World Aquarium | 9 blocks
Dallas Holocaust Museum/Center for Education and Tolerance | 8 blocks
Dallas Museum of Art | 12 blocks
Morton H. Meyerson Symphony Center | 19 blocks
AT&T Performing Arts Center | 20 blocks
JFK Memorial | 3 min

SPORTS

American Airlines Center (home of the Dallas Mavericks and Dallas Stars) | 17 blocks
AT&T Stadium (home of the Dallas Cowboys) | 24 min

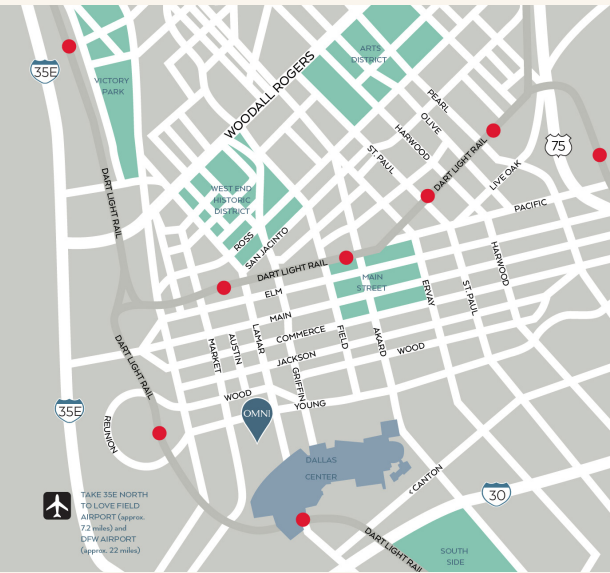

OMNI DALLAS HOTEL
555 S LAMAR
DALLAS, TEXAS 75202
214.744.6664
OMNIHOTELS.COM/DALLAS





OMNI DALLAS

OMNIHOTELS.COM/DALLAS
DALDTN.LEADS@OMNIHOTELS.COM