

Meeting Spaces.

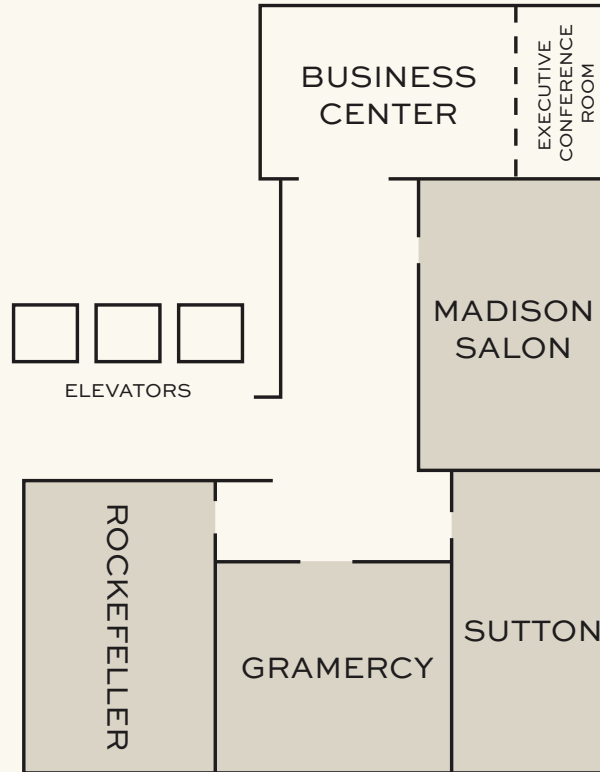

	WINDOWS	SQUARE FOOTAGE	DIMENSIONS L X W	CEILING HEIGHT	PORTABLE WALLS	THEATER	CLASS-ROOM 18"	BANQUET 72"	U-SHAPE	RECEPTION	CONFERENCE
FIRST FLOOR											
MADISON SALON	Y	459	17' X 27'	8'4"	-	44	24	30	20	30	24
SUTTON	Y	302	13' X 23'	8'4"	-	20	22	20	12	20	16
ROCKEFELLER	Y	308	14' X 22'	8'4"	-	-	-	-	-	-	12
GRAMERCY	Y	289	17' X 17'	8'4"	-	20	12	16	6	16	8

MEETING ROOM CAPACITIES WERE DETERMINED USING 72" ROUNDS OF 10 (ROUNDS CAPACITY), THREE CHAIRS PER 6'X30" TABLE (U-SHAPE CAPACITY) AND THREE CHAIRS PER 6'X18" TABLE (CLASSROOM CAPACITY) ALLOWING FOR MINIMAL AUDIOVISUAL EQUIPMENT.

SECOND FLOOR MEETING SPACE

(Per day fee)

- Madison | \$2,000
- Sutton | \$1,200
- Rockefeller | \$1,000
- Gramercy | \$800