

Flexible, Next Generation Event & Meeting Space.

4TH FLOOR

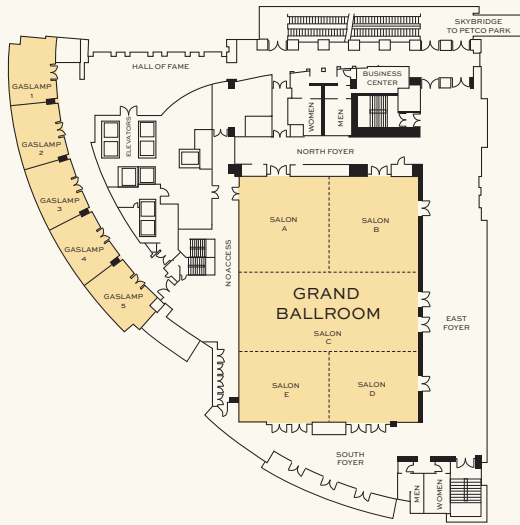

5TH FLOOR



6TH FLOOR



GROUND FLOOR GALLERY

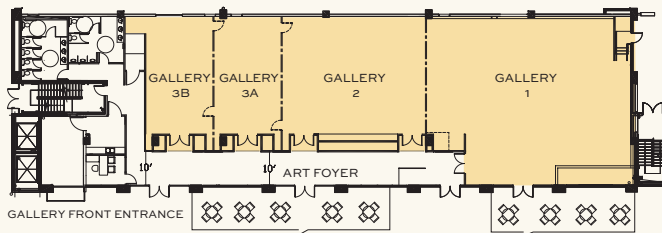

19TH FLOOR SKYBOX

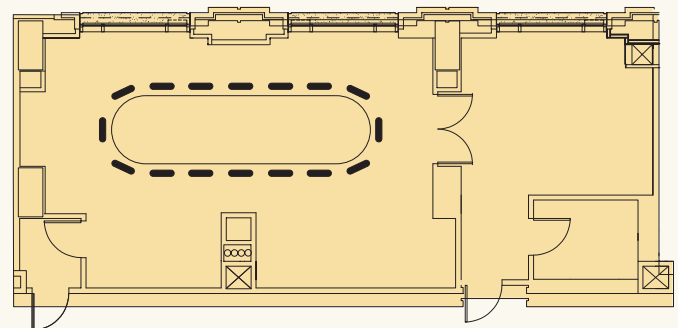

	SQUARE FOOTAGE	DIMENSIONS	CEILING HEIGHT	BANQUET 72"	CLASSROOM 18"	CONFERENCE	THEATER	RECEPTION	EXHIBIT 8 X 10	EXHIBIT 10 X 10	HOLLOW SQUARE
FLOOR 4											
GRAND BALLROOM	9,266	82' x 113'	19'	600	495	-	800	1,200	59	47	-
BALLROOM A	1,804	41' x 44'	19'	100	96	-	140	175	11	9	40
BALLROOM B	1,804	41' x 44'	19'	100	96	-	140	175	11	9	40
BALLROOM C	2,870	82' x 35'	19'	160	108	-	300	300	18	14	50
BALLROOM D	1,394	41' x 34'	19'	80	72	-	125	150	-	-	40
BALLROOM E	1,394	41' x 34'	19'	80	72	-	125	150	-	-	40
GASLAMP 1	594	22' x 27'	10'	50	32	24	55	63	-	-	26
GASLAMP 2	594	22' x 27'	10'	50	32	24	55	63	-	-	26
GASLAMP 3	594	22' x 27'	10'	50	32	24	55	63	-	-	26
GASLAMP 4	594	22' x 27'	10'	50	32	24	55	63	-	-	26
GASLAMP 5	594	22' x 27'	10'	50	32	24	55	63	-	-	26
FLOOR 5											
BALBOA 1	532	28' x 19'	10'6"	40	25	22	45	53	-	-	20
BALBOA 2	532	28' x 19'	10'6"	40	25	22	45	53	-	-	20
BALBOA 3	532	28' x 19'	10'6"	40	25	22	45	53	-	-	20
BALBOA 4	532	28' x 19'	10'6"	40	25	22	45	53	-	-	20
FLOOR 6											
BOARDROOM 1	544	34' x 16'	9'	-	-	20	-	-	-	-	-
BOARDROOM 2	544	34' x 16'	9'	-	-	20	-	-	-	-	-
TORTUGA TERRACE	4,000	-	-	170	-	-	-	300	-	-	-
SAIL TERRACE	1,000	-	-	70	-	-	-	90	-	-	-
FLOOR 19											
SKYBOX	850	-	10'	-	-	15	-	-	-	-	-
GROUND FLOOR											
ACE PORTER	2,600	-	-	120	-	-	-	200	-	-	-
ACE PORTER MEZZANINE	1,645	-	-	60	-	-	-	85	-	-	-
GALLERY	4,794	-	-	350	-	-	-	367	-	-	-
GALLERY 1	2,061	62' x 50'	11'2"	180	164	49	220	250	-	-	60
GALLERY 2	1,355	41' x 33'	12'	96	80	34	198	150	-	-	35
GALLERY 3A	730	22' x 33'	12'	36	40	22	102	75	-	-	38
GALLERY 3B	647	19' x 33'	12'	48	35	22	80	75	-	-	30

MEETING ROOM CAPACITIES WERE DETERMINED USING 72" ROUNDS OF 10 (ROUNDS CAPACITY), THREE CHAIRS PER 6'X30" TABLE (U-SHAPE CAPACITY) AND THREE CHAIRS PER 6'X18" TABLE (CLASSROOM CAPACITY) ALLOWING FOR MINIMAL AUDIOVISUAL EQUIPMENT.