



MEETING & EVENT
GUIDE

OMNI  HOTELS
& RESORTS
san francisco

OMNIHOTELS.COM/SANFRANCISCO



NEVER STAY THE SAME

Omni San Francisco Hotel provides luxurious accommodations in the heart of downtown San Francisco — the jewel of California. This beautiful downtown hotel is located right on the cable car line and is only a short walk to Union Square, the San Francisco neighborhood that has become a mecca for high-end shopping and art galleries.

EVENTS IN THE CITY

The Omni San Francisco Hotel features nine flexible meeting rooms with more than 11,000 square feet of function space, including the 2,800-square-foot Grand Ballroom. The 1926 San Francisco landmark has been restored and updated with modern amenities.

MEET HERE AND STAY HERE, TOO

The hotel offers modern amenities in a boutique ambiance due to its Florentine Renaissance architecture. All 362 guest rooms and suites exude modern luxury and classic sophistication. Here you will discover plush beds, elegant marble vanities in every bath, expansive ceilings and beautiful crown molding.

AT YOUR SERVICE AROUND THE CLOCK

The Omni San Francisco Hotel offers a variety of on-site amenities to enjoy during your visit. Stay connected in the fully-equipped business center and stay active in our dynamic Fitness Center, both open 24/7. Retreat to your luxurious guest room and order a delicious meal from our expansive in-room dining menu, also available around the clock.

SATIATE YOUR ECLECTIC PALATE

The Omni San Francisco Hotel's Culinary team can create the perfect menu for your special event or corporate meeting. Discover the tastes and textures of California from the finest prime beef, high quality meats and fish, locally farmed produce and the most decadent desserts. Omni San Francisco Hotel offers a local experience like no other for breakfast, lunch and dinner as well as a delicious selection of signature cocktails and beverages at Bob's Steak & Chop House Bar.

OMNI SAN FRANCISCO HOTEL MEETING SPACE

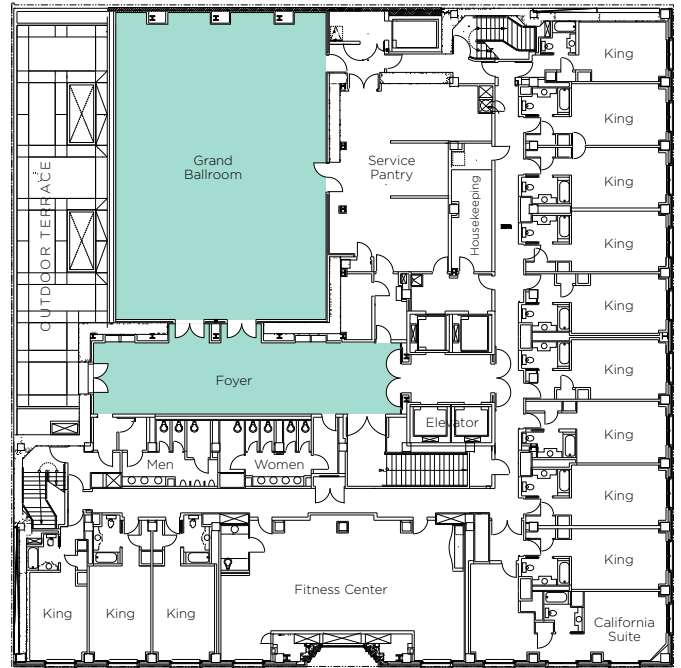
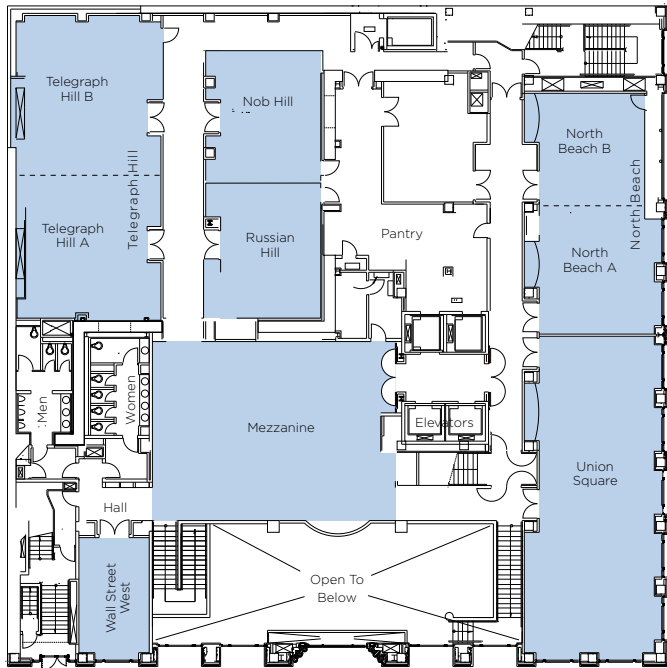

OMNI SAN FRANCISCO HOTEL MEETING ROOM CAPACITY

	SQUARE FOOTAGE	DIMENSIONS	CEILING HEIGHT	FLOOR COVERING	PORTABLE WALLS	THEATER	CLASSROOM 18'	BANQUET 60'	BANQUET 72'	RECEPTION	HOLLOW SQUARE	EXHIBITS 8' X 10'	CONFERENCE	U-SHAPE	
THIRD FLOOR															
GRAND BALLROOM	2,800	44' x 63'8"	15'	CARPET	NO	320	180	190	228	300	70	17	60	70	
FOYER	960	64' x 15'	9'	CARPET	—	—	—	—	—	80	—	—	—	—	
SECOND FLOOR															
MEZZANINE	1,500	50' x 30'	9'6"	CARPET	—	—	—	110	120	175	—	9	—	—	
TELEGRAPH HILL	1,827	29' x 63'	9'	CARPET	YES	120	100	130	120	190	60	11	50	48	
TELEGRAPH HILL A	812	29' x 28'	9'	CARPET	YES	50	40	50	48	45	30	—	24	24	
TELEGRAPH HILL B	1,015	29' x 35'	9'	CARPET	YES	60	56	60	48	60	36	—	34	30	
NOB HILL	679	22'6" x 30'	9'	CARPET	NO	50	32	50	48	50	30	—	20	24	
RUSSIAN HILL	679	22'6" x 30'	9'	CARPET	NO	50	32	50	48	50	30	—	20	24	
NORTH BEACH	1,196	23' x 52'	9'	CARPET	YES	100	70	90	96	100	54	—	46	48	
NORTH BEACH A	624	24' x 26'	9'	CARPET	YES	45	40	60	48	50	24	—	20	18	
NORTH BEACH B	572	22' x 26'	9'	CARPET	YES	45	38	50	48	45	30	—	20	24	
UNION SQUARE	1,632	24' x 68'	9'	CARPET	NO	150	80	130	132	150	54	10	54	46	
WALL STREET WEST	335	14' x 24'	9'6"	CARPET	—	—	—	—	—	—	—	—	12	—	



SAN FRANCISCO HIGHLIGHTS

Located 20 miles from the San Francisco International Airport. The hotel is located directly on the cable car line and is a short walk to Union Square.

ATTRACTIONS

Cable Car
Ferry Building
The Embarcadero
China Town
North Beach
Alcatraz

ARTS & CULTURE

Museum of Modern Art
San Francisco Railway Museum
Yerba Buena Center for the Arts
Exploratorium
California Academy of Sciences

SHOPPING

Gump's
Neiman Marcus
Saks Fifth Avenue
Nordstrom's
Bloomingdales
Much more at Union Square

DINING & ENTERTAINMENT

Wayfare Tavern
Tadich Grill
Hakkasan
Kokkari Estiatorio
Slanted Door

OMNI SAN FRANCISCO HOTEL
500 CALIFORNIA ST.
(AT MONTGOMERY)
SAN FRANCISCO, CA 94104
415-677-9494
OMNIHOTELS.COM/SANFRANCISCO

